

ROTO-JET PUMP

High Pressure Pitot Tube Pumps

Model 2100
Grease Lubricated

Excellent
Power & Industrial
Solutions



High pressure multi-stage performance with the cost advantage, simplicity and reliability of a

Benefits of the Roto-Jet 2100 Pump

• Improved Design

- Lower Energy Cost—Higher efficiencies using improved patented hydraulics
- Flexible Installation—Footprint interchangeable with Roto-Jet models RG and 2200
- Low Maintenance Cost—Simplified design means less maintenance

• Enhanced Reliability

- Fewer parts—Pick-Up Tube Locknut design
- Seal designed for low pressure—improves overall seal life
- Isolated bearing pedestal—minimizes risk of bearing contamination

• Improved Performance

- Broad range of speed, flow, and pressure capabilities
- Hydraulically stable along the entire performance curve and beyond BEP
- Enhanced hydraulics over previous designs



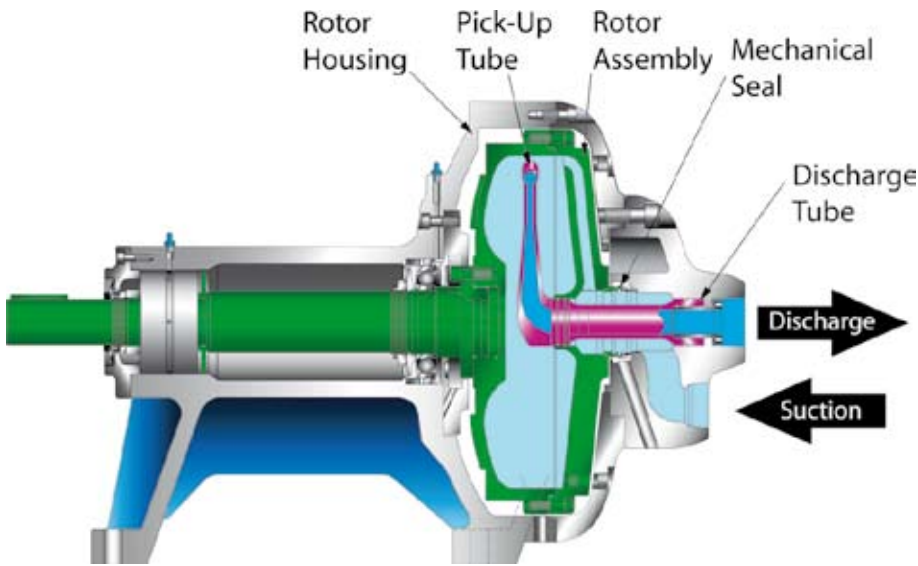

Typical Roto-Jet Model 2100 Applications

- Food and Beverage cleaning systems
- Reverse osmosis systems
- Automotive gun drilling coolant
- Spraying/washing systems
- High pressure paper shower
- Circuit board wash systems
- Water/process injection systems
- Seal flushing systems
- Boiler feed/cleaning systems
- And many, many more...

Specifications - Model 2100

Maximum Temperature	180°F/82°C
Max Temperature - w/flush	250°F/121°C
Maximum Suction Pressure	200 PSI/14 Bar
Maximum Head	3000 Ft./911m
Maximum Speed	4709 RPM
Maximum Flow	465GPM/105m ³ /hr
Maximum Horsepower	400 HP/290 KW
Weight	825 Lbs./544 Kg
Lubrication	Grease

Materials of Construction	Stainless Steel Pump	Ductile Iron Pump
Rotor	316. SS	Ductile Iron
Rotor Cover	316. SS	Ductile Iron
Manifold	316. SS	Ductile Iron
Endbell	Ductile Iron	Ductile Iron
Pickup Tube	17-4 PH	Ductile Iron
Shaft	AISI-4140	AISI 4140

Note: 2x2 and 3x2, NPT and 3x2 flanged manifolds are all available in ductile iron and 316 Stainless Steel.

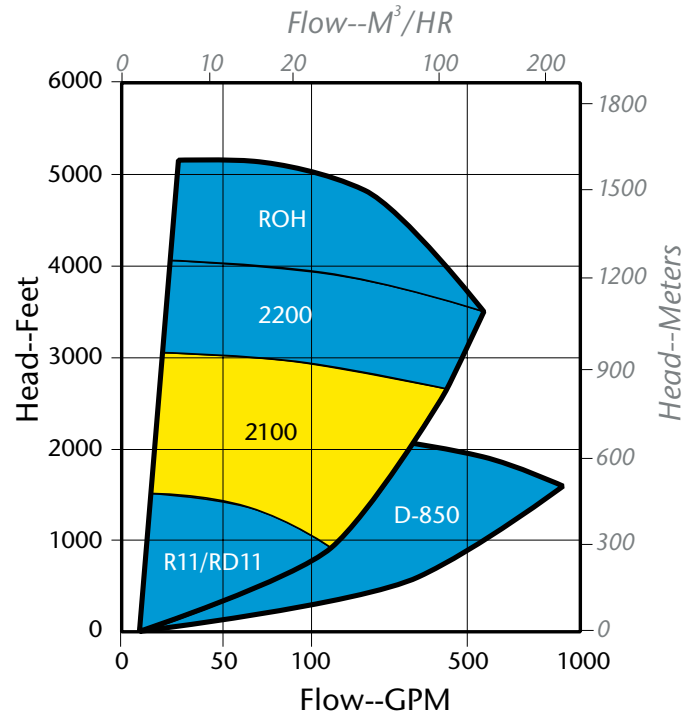

Note:
Dimensions are for general reference only and will vary with actual model selected. Available with flanged connections.

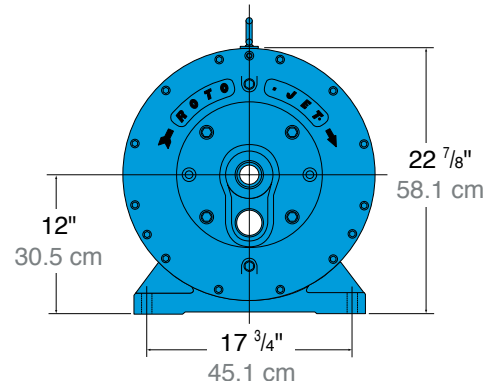
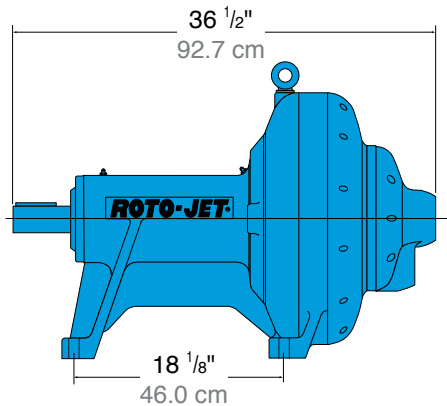

Weir Specialty Pumps

440 W. 800 South
P.O. Box 209 (84110-0209)
Salt Lake City, UT 84101
USA

Tel: 1 801 359 8731
Fax: 1 801 530 7531
email: info@weirsp.com
www.weirsp.com

© 2009 Weir Specialty Pumps. All Rights reserved. Bulletin RJ-2100

Excellent
Power & Industrial
Solutions

